

CALIBER® V-Front Ramp Shield™

Installation Instructions for Part No. 13404

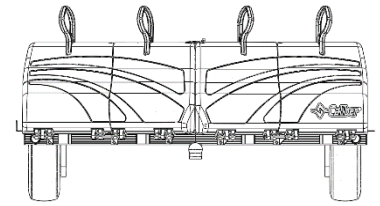

TOOLS REQUIRED:

- Power Drill with Clutch and 3/8" Drill bit
- T20 Torx (Included)
- Hand Screwdriver
- 7/16" Socket w/ 1/4" drive
- 1/2" Socket & 1/2" wrench
- Tape Measure
- Pencil or Marker
- Hammer, vice grips and C-Clamp

HARDWARE INCLUDED:

Qty	Description
3	33 Pack of Stainless Steel Screws
6	1/2" Stainless Pins (2pc. 10-3/4" & 4pc. 6") w/ End Caps
12	5/16"x 2-1/2 SS Bolts, (24) washers and 12 lock Nuts
12	1/4"x2-1/2" SS Lag Screws, 36 washers and 12 lock washers
1	Rubber Retainer Strap
8	1/4" x1-1/2" SS Lag Screws and 8 washers
6	Aluminum Brackets

READ ALL INSTRUCTIONS CAREFULLY PRIOR TO INSTALLATION

SOME TRAILERS WILL REQUIRE ADDAPTER KIT (i.e. Aluma and SledBed) SOME TRAILERS WILL NOT ACCEPT THIS SHIELD (i.e. Triton Double Axle)

STEP 1: Lay shield halves down on a flat surface and attached the shields together. Press firmly on the top shield to make sure the fasteners go directly in the bottom shield. Screw in (4) 1.5" lag screws and washers. Torque gently with 7/16" ratchet until the shield halves pull together. Repeat this step with the other half of the shield. This step will require (8) 1.5" lag screws and washers. **Do not to over tighten the lag screws.**

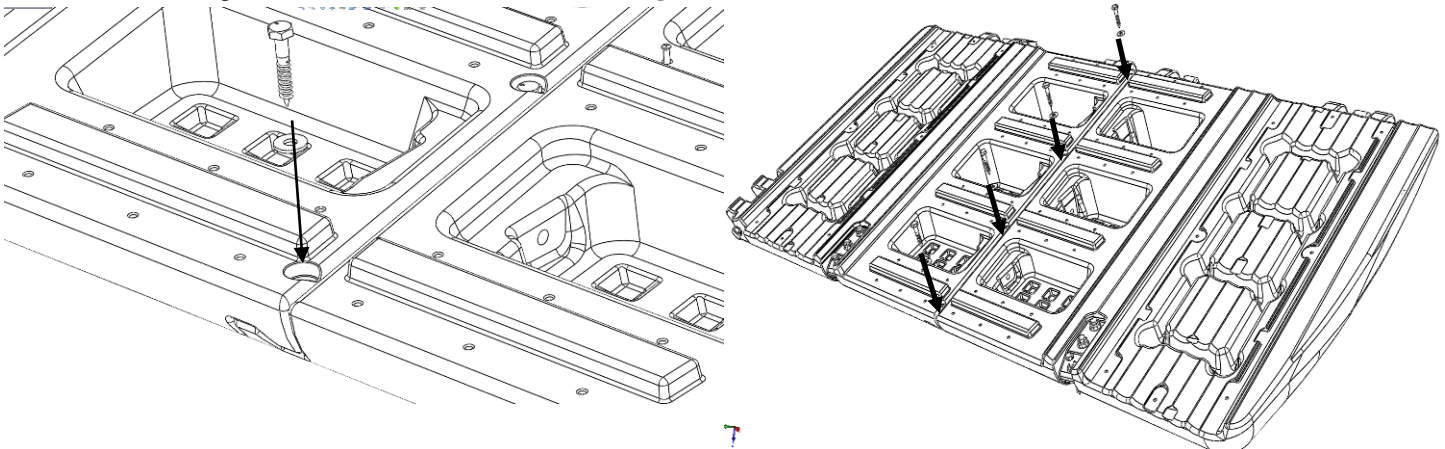

STEP 2: Place Grips on shield as shown below, carefully align all (8) 1" Truss Head Screws in the holes. Make sure the screws fall into the pilot holes **even if they are angled slightly.** Screw them in and torque them by screw driver or drill (lightest clutch setting) until the Grips pull snug to the shield. Repeat with the remaining 7 grips. **Do not over tighten the screws.**



CALIBER®
952-985-9999

SHIELD.docx

www.caliberproductsinc.com

Assembled on 19 May 2020

C:\Users\Greg\W.DOMAIN\Dropbox (Caliber Dropbox)\Caliber Dropbox Team Folder\Instructions\13404 - V-FRONT RAMP

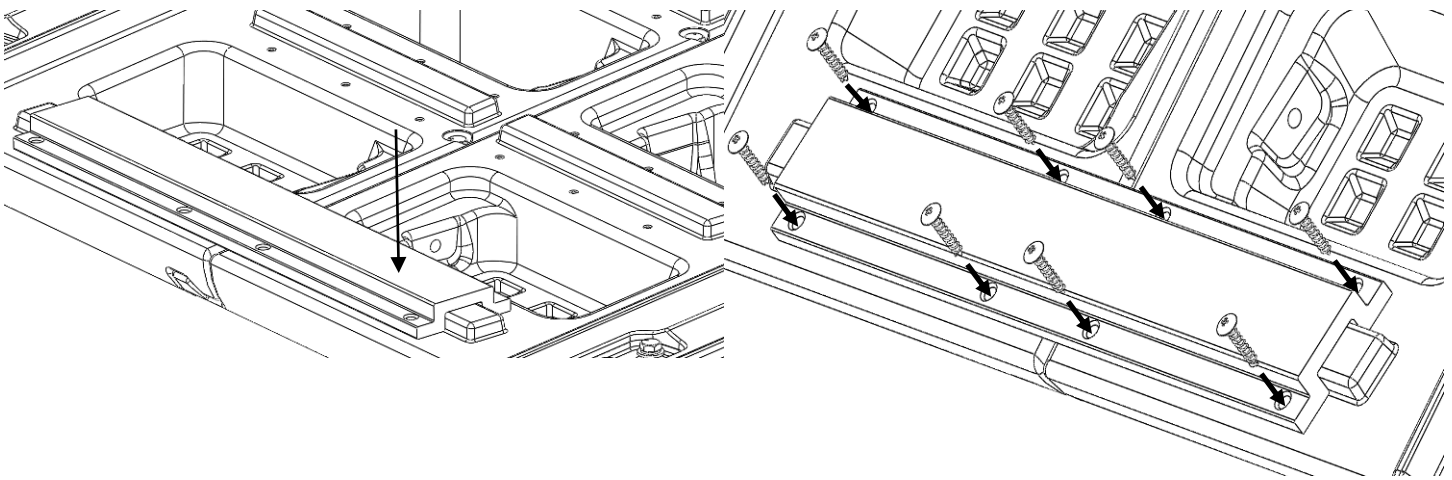

STEP 3: Screw in (3) 2.5" Hex Lag Screw, Stack of 3 Washers per hole and Lock Washers as displayed below. Make sure left handles go on left shields and right on right. Align the fasteners straight into the holes of the shield and into the pilot holes of handles. Align and fasten bottom fastener first. **Do not over tighten.** If you over tighten, the screw may protrude on the front side of the handle. Be careful to watch the front of the handle to make sure you don't go too far.

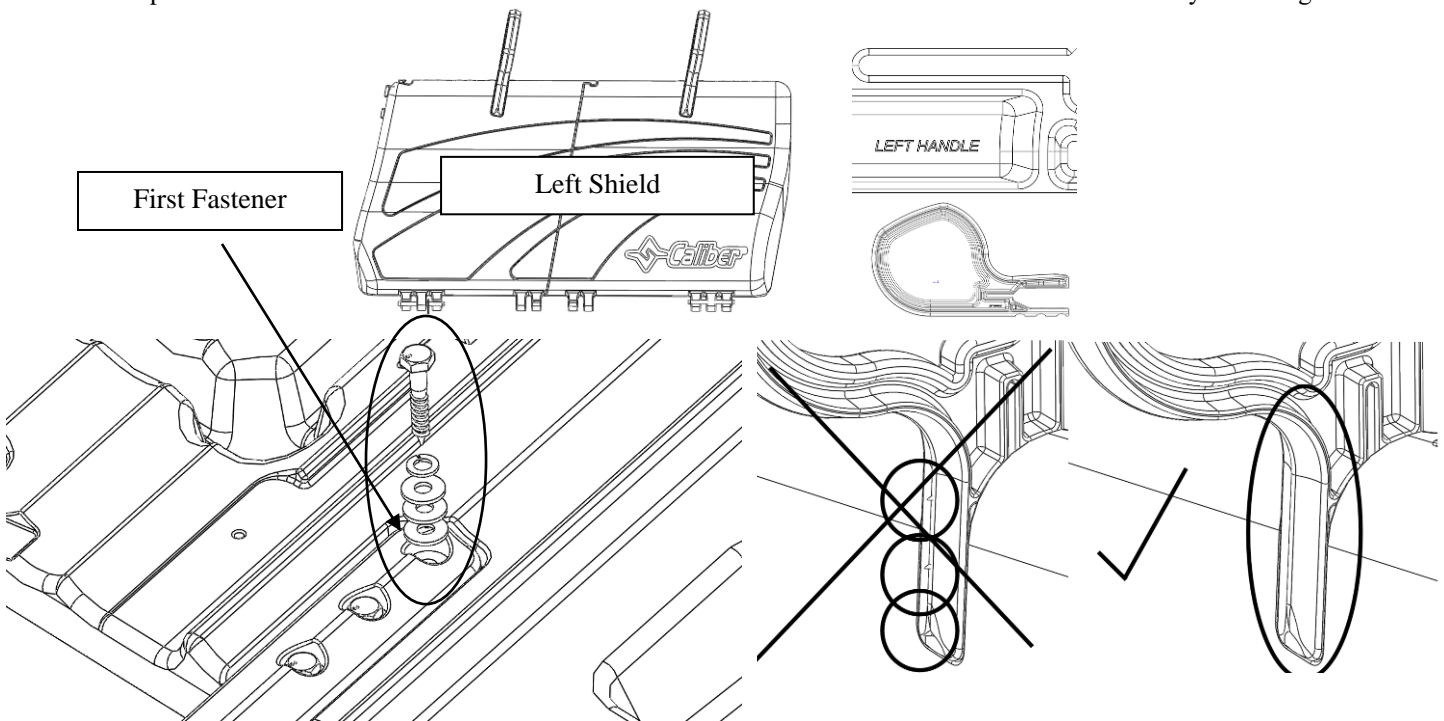

STEP 4: Align the LowPro Grip Glide with left Shield and screw in (28) 1" Truss Head Screws starting in the center first, then the outside as show below (Some may be partially installed) Do **not over tighten.**

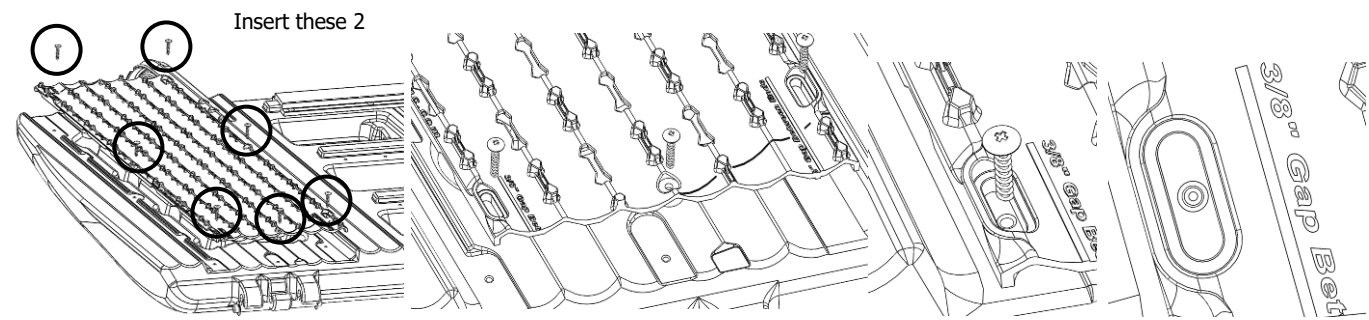

CALIBER®
952-985-9999

SHIELD.docx

www.caliberproductsinc.com

Assembled on 19 May 2020

C:\Users\Greg\W\DOMAIN\Dropbox\Caliber Dropbox\Caliber Dropbox Team Folder\Instructions\13404 - V-FRONT RAMP

STEP 5: Drill first 2 holes on left side of the trailer for 1st bracket closest to nose of the trailer. Holes should be 3/8" diameter and drilled 1 -1/2" down from top of trailer top edge and 8" from nose of trailer. Use provided bracket to drill second hole 1-1/2" below first hole. Insert 5/16"x2.5"bolts along with large fender washers on face of bracket followed by washer and lock nut in back. Fasten tight with a 1/2" wrench. **Some models require hinge bolts with threads the full length (not included).**

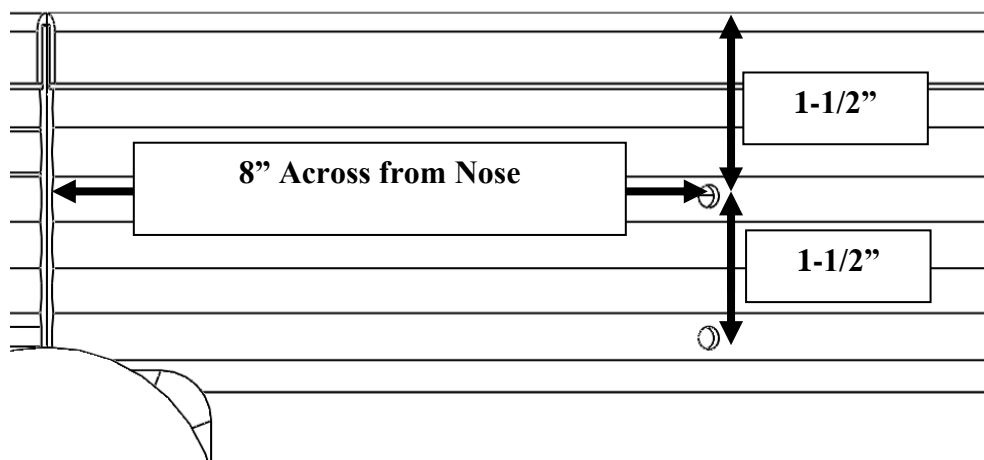
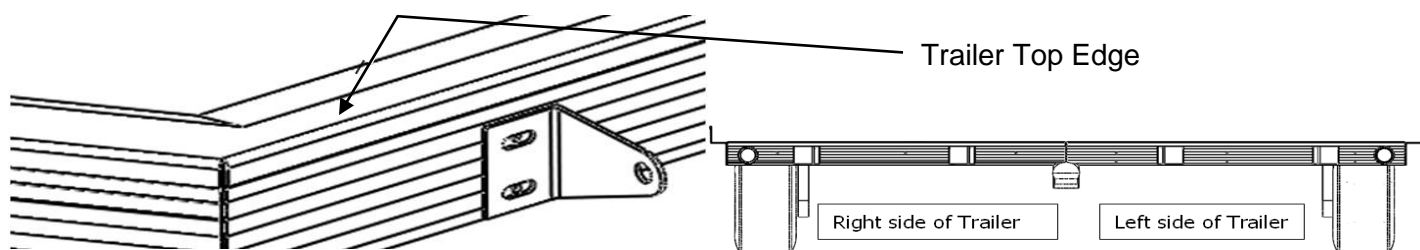

CONTINUED

STEP 5: Next insert 6" Hinge Pin into provided end cap. **Do not put both end caps on.** Insert hinge pin through shield fingers and hole in mounting bracket. Next lift the shield in place horizontally to locate the 2nd 6" pin bracket location on the outside edge. Follow the same 1-1/2" distance down for both holes. The distance across should be determined so the bracket fits in between the fingers. The 3rd bracket again is positioned with the same down dimensions but should be placed closer to the outside of the trailer preferably in between the large gap. After the 3rd bracket and hinge pin are

CALIBER[®]
952-985-9999

SHIELD.docx

www.caliberproductsinc.com

Assembled on 19 May 2020

C:\Users\GregW\DOMAIN\Dropbox (Caliber Dropbox)\Caliber Dropbox Team Folder\Instructions\13404 - V-FRONT RAMP

assembled move shield up and down, back and forth for any fine-tune adjustments. Repeat **STEP 5** for brackets 4 through 6. After final adjustments are made, grip pins with vice grips and tap on other end caps. A C-Clamp can be also be used to hold pin in place while attaching last pin caps.

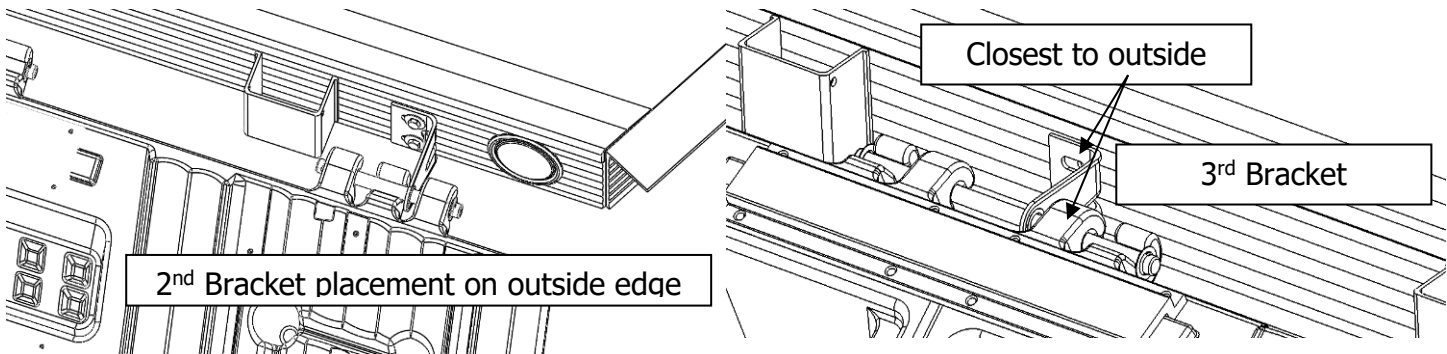
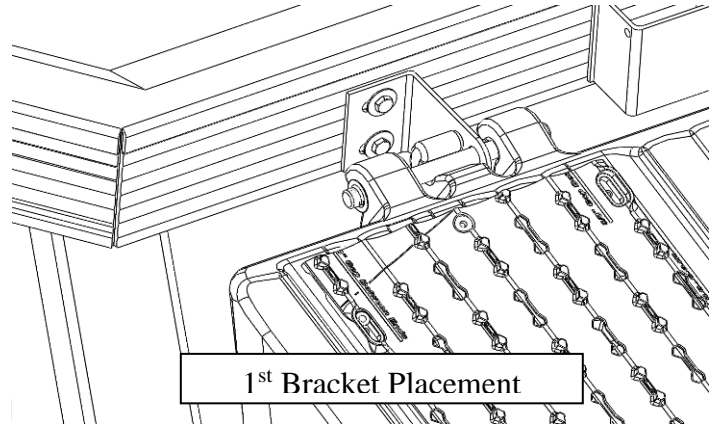
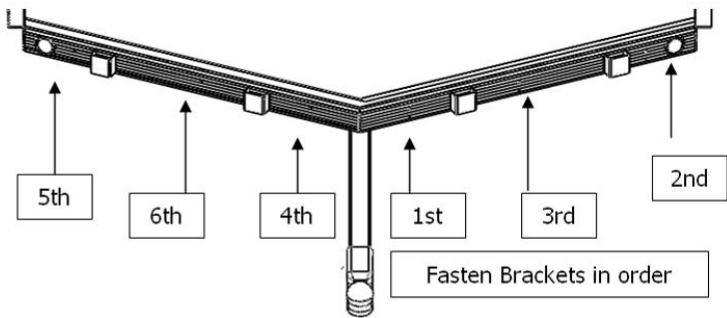

STEP 6: Firmly press rubber strap onto post and carefully tighten the fastener to the shield. **Do not over tighten.** An optional Clevis Pin hole through the interlocking fingers can be drilled out if there is additional concern of latch failure. Make sure full assembly is completed and closed tightly prior to drilling. Use a 5" pin to fasten prior to latching the rubber strap.

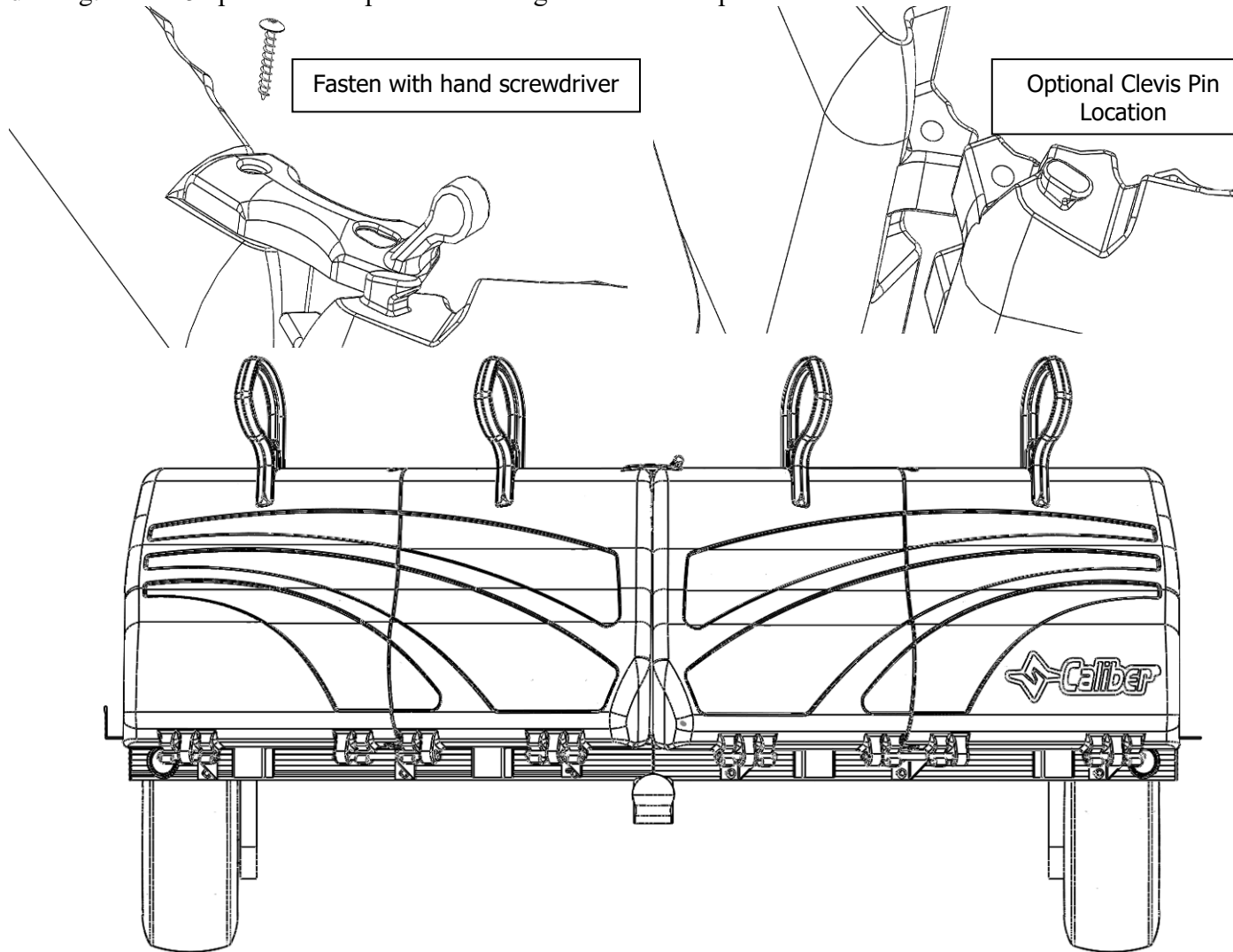

INSTALLATION NOTE: Trailer jack may need to be move forward towards the ball coupler for shield clearance.

WARNING: Do not stand behind Snowmobiles or ATV's when loading/unloading. Always load Snowmobiles and ATV's at low speeds using extreme caution.

CALIBER, INC. LIMITED LIFETIME WARRANTY

CALIBER®
952-985-9999

SHIELD.docx

www.caliberproductsinc.com

Assembled on 19 May 2020

C:\Users\GregW\DOMAIN\Dropbox (Caliber Dropbox)\Caliber Dropbox Team Folder\Instructions\13404 - V-FRONT RAMP

Caliber, Inc. warrants that this product will be free from defects in material or workmanship under normal use, installation and service. Caliber, Inc. reserves the right, before having any obligation under this limited warranty, to inspect the damaged Caliber product. All warranty shipping costs for inspection shall be borne solely by the purchaser. This limited warranty is non-transferable. Contact Caliber, Inc. at www.caliberproductsinc.com or at 952-985-9999 for warranty service procedures.

DISCLAIMER

Caliber, Inc. shall not be liable for any special, incidental or consequential damages, including, but not limited to, lost revenues, lost profits, personal injury, damage to property, and third-party claims, arising out of any warranty, contract, statutory or tort. Notwithstanding the term of any limited warranty or any warranty implied by law, or in the event that any limited warranty fails of its essential purpose, in no event will Caliber's entire liability exceed the purchase price of this product.

CALIBER®
952-985-9999

SHIELD.docx

www.caliberproductsinc.com

Assembled on 19 May 2020

C:\Users\GregW.DOMAIN\Dropbox (Caliber Dropbox)\Caliber Dropbox Team Folder\Instructions\13404 - V-FRONT RAMP